

AVENUE FIVE



43 Macfarlane Street Marshall VIC

3 2 2

Located only 750m to Marshall train station and under 10 minutes to both Waurin Ponds shopping centre and Armstrong Creek Town Centre, 43 Macfarlane Street offers stylish family living in one of Geelong's best value suburbs.

Set on approx. 476m², the home is equipped with three good-sized bedrooms, making it perfect for a family or downsizers. The master bedroom has feature timber panelling and bedside pendant lamps which add the extra touch of class that people are searching for, and offers a walk in robe and ensuite.

The other two bedrooms, both well proportioned, contain built in robes with sliding-doors to make the most of the space. Other features of the home include the naturally lit, central bathroom which offers a semi-frameless shower, full size bath and oversize sink and the laundry is complete

Price : \$ 773,000
Land Size : 470 sqm
View : <https://www.avenuefive.com.au/sale/vic/geelong-district/marshall/residential/house/6946209>



Sam Parsons
5241 6968

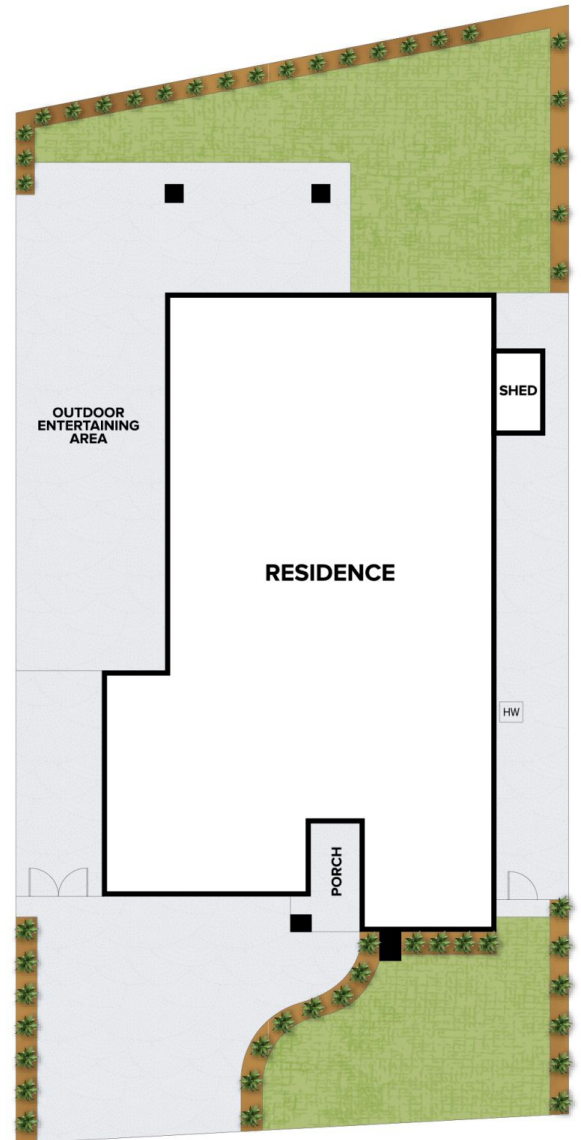

43 MACFARLANE STREET, MARSHALL

AVENUE FIVE