

# AVENUE FIVE



## 5 Pickett Crescent Belmont VIC

3 1 2

If you've been searching for a classic family home, in a sought after location on a large allotment of 811m2 approx then look no further. Offered to the market for the first time in over 55 years this loving family home awaits its new owner to take care of it as is, or further enhance, renovate or extend stca.

Impeccable street appeal with gable facade, large front entry verandah and yard, off street parking for up to 3 cars and character cream bricks.

Enter via veranda and be greeted with 3 bedrooms, central bathroom, original timber scallop wall panelling and large living room bathed in sunlight with open access to original timber kitchen.

A second living or rumpus option has been added to enjoy

**Price** : \$690,000 - \$725,000  
**Land Size** : 811 sqm  
**View** : <https://www.avenuefive.com.au/sale/vic/geelong-district/belmont/residential/house/6862157>



**Sam Parsons**  
5241 6968



**Luke Eustace**  
5241 6968

# 5 PICKETT CRESCENT, BELMONT

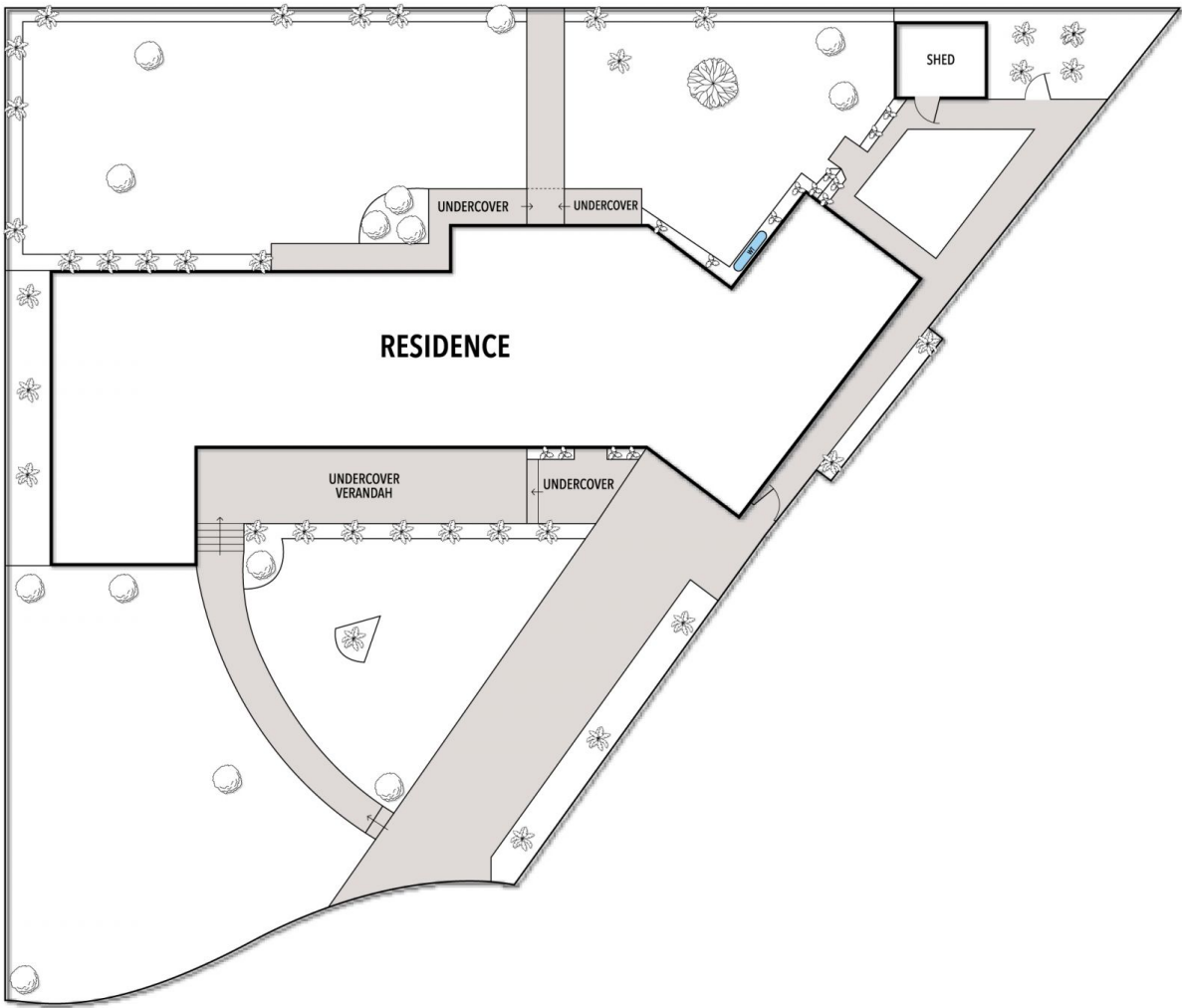
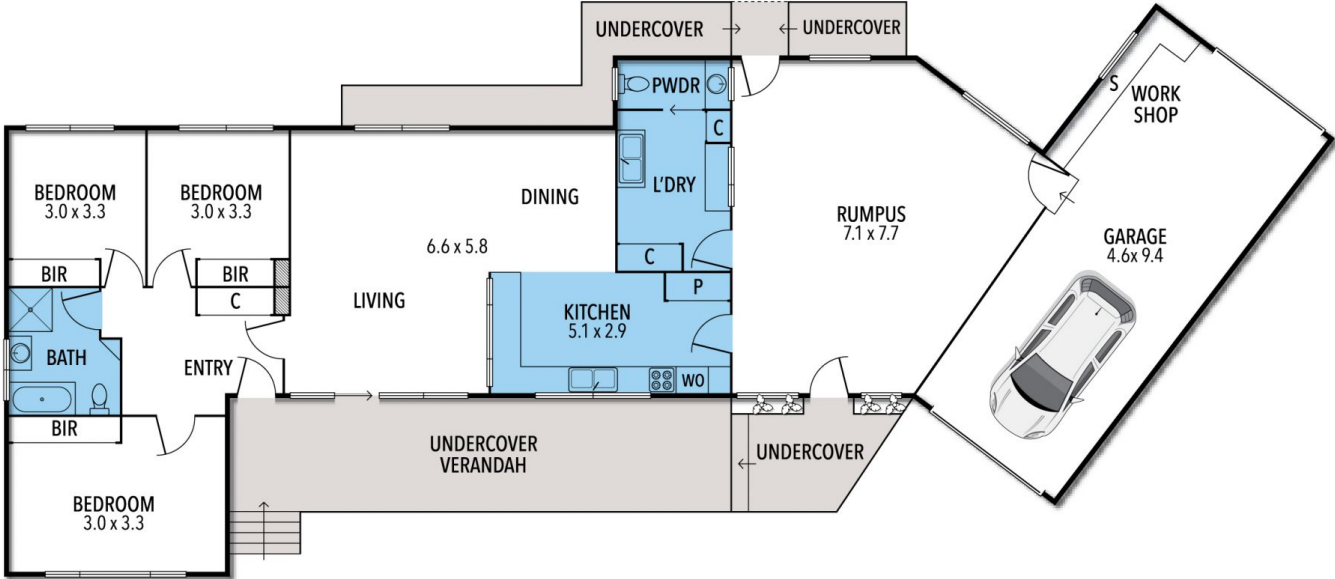

THE ABOVE PLAN IS AN ARTIST'S IMPRESSION ONLY, IT INCLUDES ELEMENTS THAT ARE FOR DISPLAY PURPOSES ONLY AND MAY NOT BE TO SCALE. LANDSCAPING SHOWN IS INDICATIVE ONLY. DIMENSIONS ARE APPROXIMATE.